

Franklin Square in Photos

Right: Franklin Square, circa 1961. A baseball diamond is visible on the north end of the park and an early version of a play structure is visible on the south end. Far right: An architect's 1963 sketch of Franklin Square.

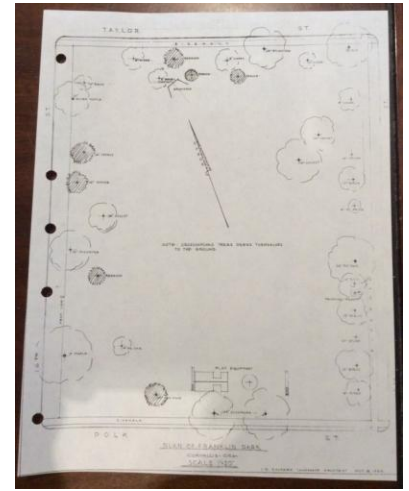

Below: Photos of the (now removed) Franklin Square play structure in use.



Below: Refurbishment work party in February 2010



Below: April 2014 photos of the rotted footings that necessitated the removal of the Franklin Square play structure.



Below, left: Neighborhood kids playing soccer at the September 2014 JANA picnic. Below, right: A lone swingset remains.

